

概述

L9系列射频同轴连接器产品是按照GJB 681A-2002、IEC 60169-13、CECC 22240和DIN 47295生产的一种小型螺纹连接的同轴连接器，具有体积小、重量轻，机电性能俱佳的特点。供通讯设备和无线电仪器的高频回路中连接射频同轴电缆用。

主要技术特性

温度范围 Temperature range		-40℃ ~ +155℃	绝缘电阻 Insulation resistance		≥10000MΩ
特性阻抗 Characteristic impedance		75Ω	介质耐压 Dielectric withstanding voltage		1000V (rms)
频率范围 Frequency range		0GHz~1GHz	电压驻波比 VSWR	直式 Straight	≤1.22
工作电压 Voltage rating		330V (rms)		弯式 Right angle	≤1.40
接触电阻 Contact resistance	中心导体 Center conductor	≤0.004Ω	插入损耗 Insertion loss		0.3dB at 50kHz~233MHz
	外导体 Outer conductor	≤0.002Ω	寿命 Durability		500 Cycles

头部配合尺寸 INTERF ACE MA TING DIMENSIONS

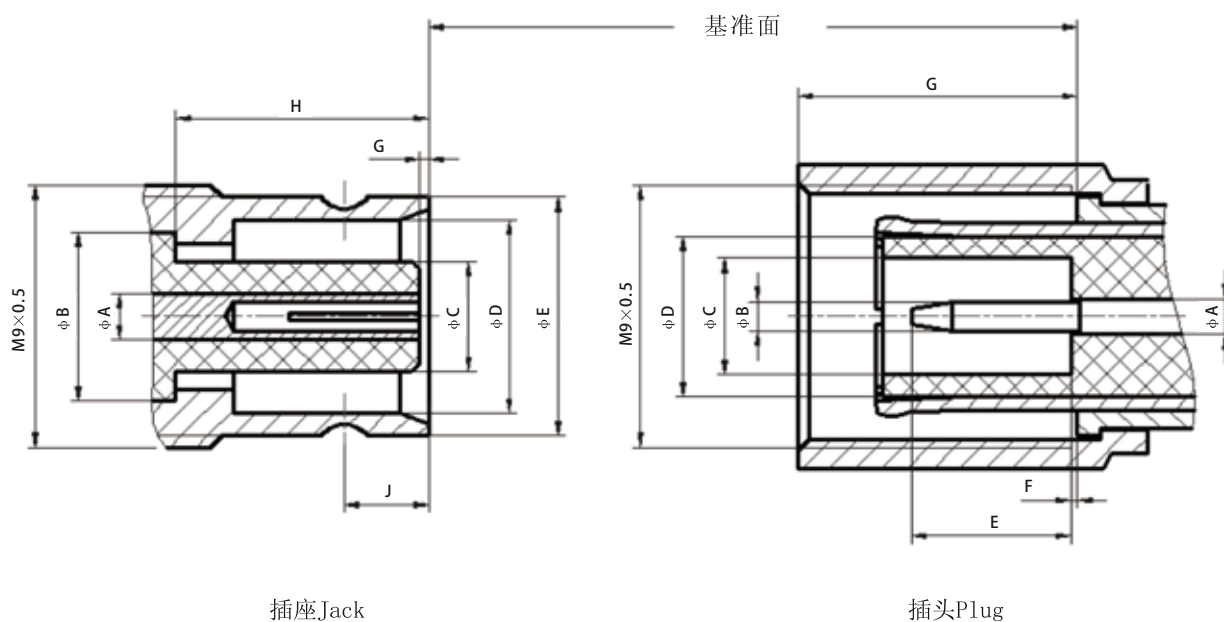

JACK (mm)			PLUG (mm)		
Symbol	MIN	MAX	Symbol	MIN	MAX
A	-	1.60	A	-	1.60
B	-	5.60	B	0.97	1.03
C	-	3.80	C	4.00	-
D	6.60	6.69	D	-	5.60
E	8.10	8.25	E	-	5.50
G	0.25	-	F	-	0.15
H	6.70	-	G	6.40	6.60
J	2.90	3.10			

电缆连接器



L9-75J3等

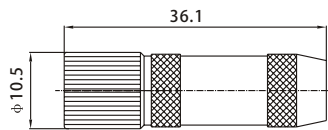

Type	Cable type
L9-75J2B	SFYE-75-2-1
L9-75J3	SYV-75-2, RG179
L9-75J4	SFF-75-2
L9-75J4-1	SYV-75-2-2
L9-75J12	SYV-75-3



L9-75JW3Y等

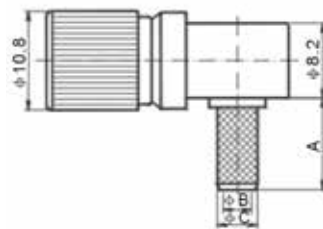

Type	A	B	C	Cable type
L9-75JW3Y	7.0	1.6	2.6	SYV-75-2
L9-75JW4Y	8.0	2.1	3.4	SYV-75-2-1
L9-75JW5Y	10.0	3.1	4.4	SYV-75-3



L9-75KY4Y

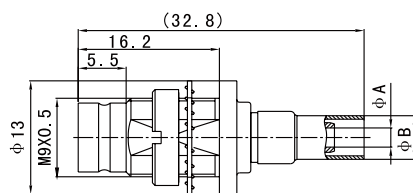

安装开孔尺寸
Mounting hole

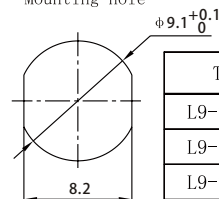

Type	A	B	Cable type
L9-75KY3Y	1.6	2.6	SYV-75-2
L9-75KY4Y	2.1	3.4	SYV-75-2-1
L9-75KY5Y	3.1	4.4	SYV-75-3

L9系列射频同轴连接器



面板连接器



L9-75KY

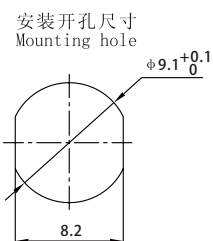
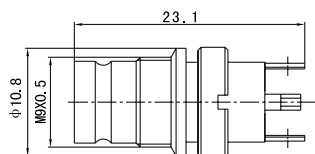

L9(M)-75KY4

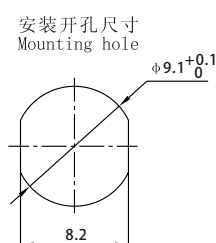
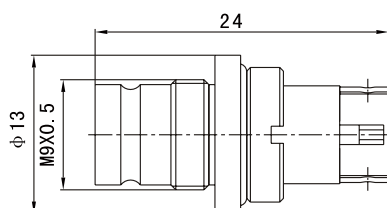

印制电路板连接器



L9-75KHD

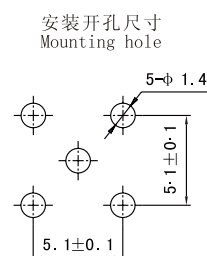
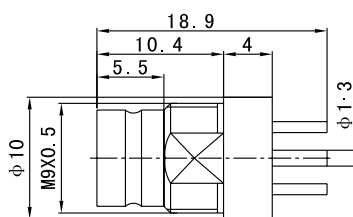

L9(M)-75KHD

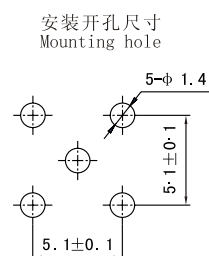
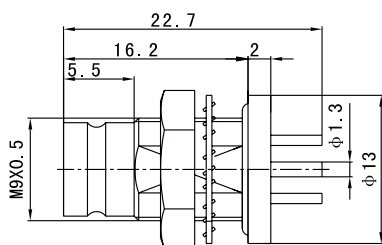

系列内转接器



L9-75KYKA

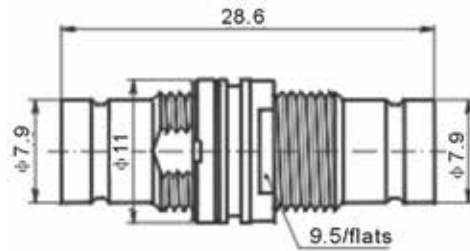

安装开孔尺寸
Mounting hole

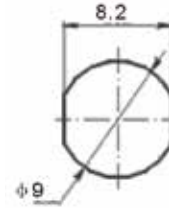

L9-75KKY5

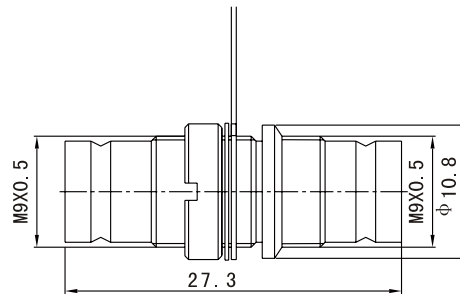

安装开孔尺寸
Mounting hole

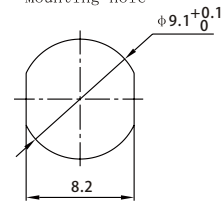

L9-75JKJW

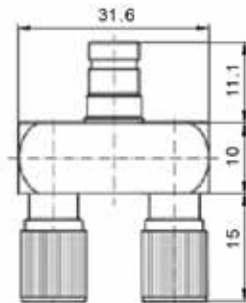

L9-75JJWW

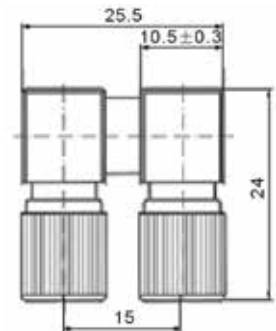

L9-75JJWW2

