

L29系列射频同轴连接器



概述

L29系列产品是按照GJB 681A-2002、IEC 60169-4和DIN 47223相关要求生产的一种较大型螺纹同轴连接器，其特点是电压驻波比小、气密性好、功率容量大、工作电压高，且大部分具有防水结构，可用于户外作为中、高能量传输的连接器，广泛用于微波传输和移动通信系统中。

主要技术特性

温度范围 Temperature range		-55℃~+155℃	绝缘电阻 Insulation resistance		≥5000MΩ
特性阻抗 Characteristic impedance		50Ω	介质耐压 Dielectric withstanding voltage		4000V (rms)
频率范围 Frequency range		0GHz~7.5GHz	电压驻波比 VSWR	直式 Straight	≤1.25
工作电压 Voltage rating		2700V(rms)		弯式 Right angle	≤1.40
接触电阻 Contact resistance	中心导体 Center conductor	≤0.0004Ω	寿命 Durability		500 Cycles
	外导体 Outer conductor	≤0.0002Ω			

头部配合尺寸 INTERFACING DIMENSIONS

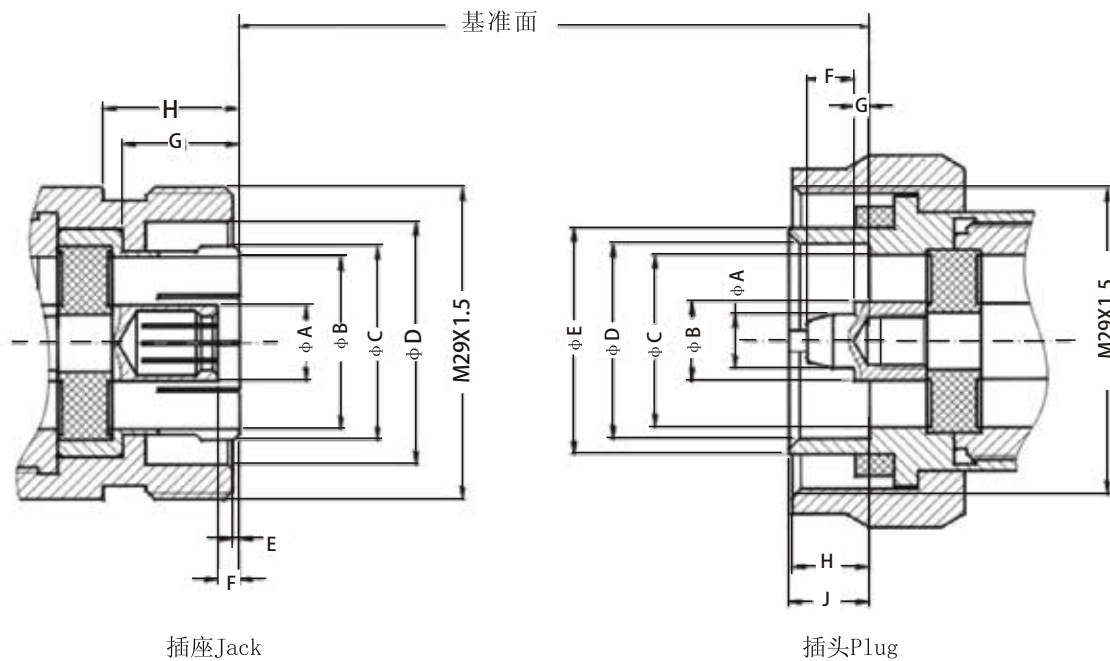

L29系列射频同轴连接器

JACK (mm)			PLUG (mm)		
Symbol	MIN	MAX	Symbol	MIN	MAX
A	7.00	-	A	4.96	5.04
B	15.85	16.25	B	7.00	-
C	-	-	C	15.85	16.25
D	22.10	22.90	D	18.03	18.21
E	0.50	0.70	E	20.60	21.40
F	1.77	2.07	F	-	4.50
G	8.10	-	G	1.47	1.77
H	10.00	-	H	7.00	9.00
			J	7.00	8.00

电缆连接器



L29-J5D等

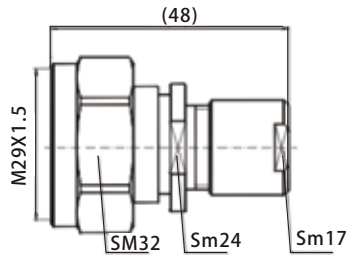

Type	Cable type
L29-J5D	SYV-50-3 RG58
L29-J7	SYV-50-7-1
L29-J8	SYV-50-7-2



L29-J1/2A等

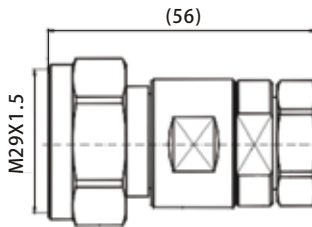

Type	Cable type
L29-J1/2A	1/2" 皱纹铜管
L29-J1/2S	1/2" 螺纹铜管
L29-J5/8A	5/8" 皱纹铜管



L29-J7等

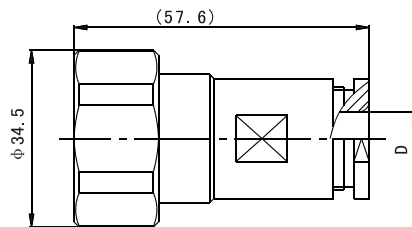

Type	D	Cable type
L29-J7	10.5	SYV-50-7
L29-J9	12.8	SYV-50-9



L29-J7/8A

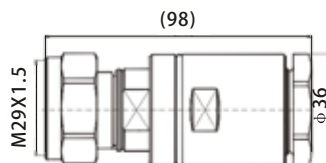

Type	Cable type
L29-J7/8A	7/8" 皱纹铜管

L29系列射频同轴连接器



面板连接器



L29-KFD

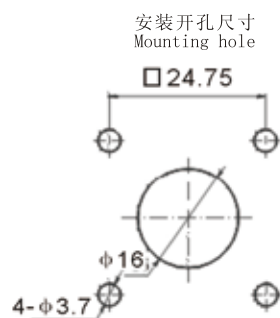
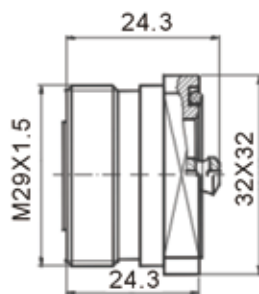

L29-JFD

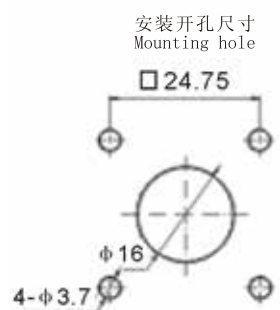
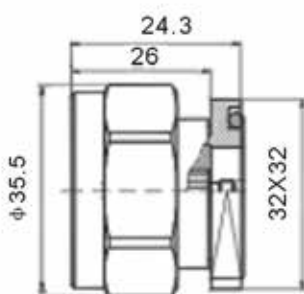

L29-KFD1

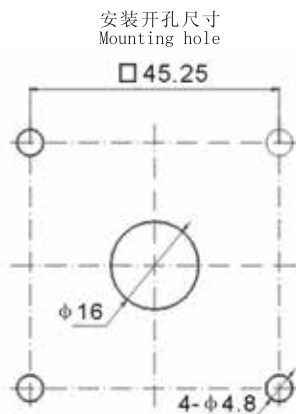
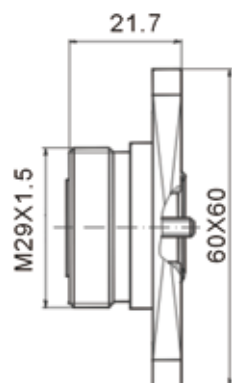

L29-KFD2

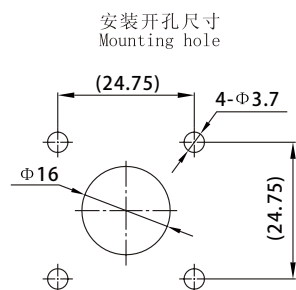
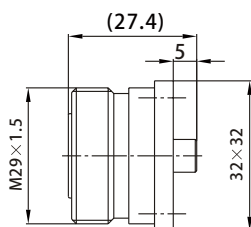



L29-KFD3

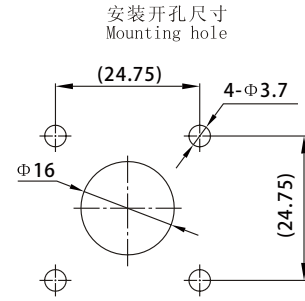
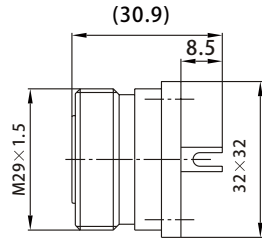

L29-50KYFD

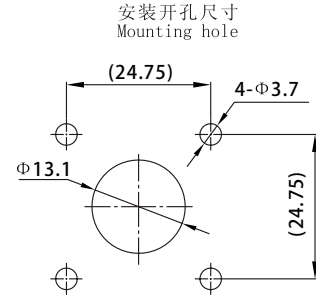
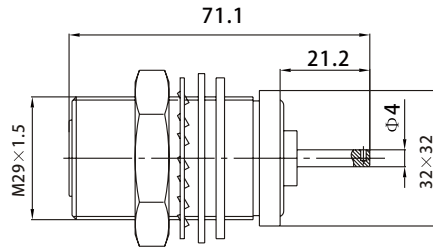

L29-50KYFD1

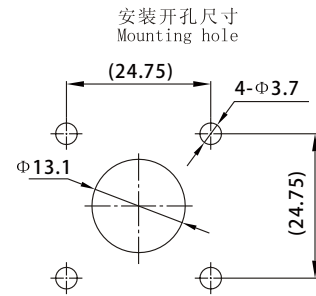
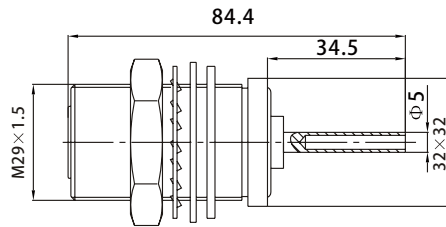

系列内转接器



L29-KKF

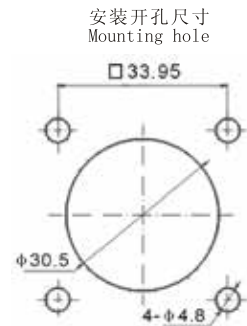
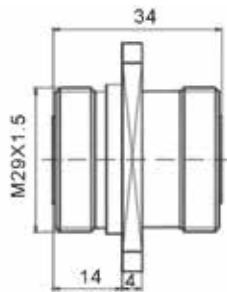

L29-KK

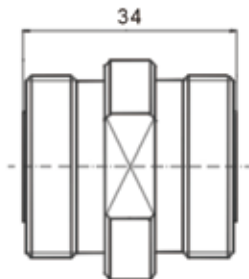

L29-JJ

