

## 概述

SSMB系列同轴连接器是按照GJB 681A-2002、IEC 60169-19和MIL-C-39012研制生产的一种微型推入式射频同轴连接器，具有体积小、重量轻、使用方便、抗振性好等特点，适用于微小无线电仪器及通信设备中连接射频同轴电缆，其特性阻抗50Ω。

## 主要技术特性

温度范围 Temperature range		-55℃~+155℃	绝缘电阻 Insulation resistance		≥1000MΩ
特性阻抗 Characteristic impedance		50Ω	介质耐压 Dielectric withstanding voltage		500V
电压驻波比 VSWR	直式 Straight	≤1.22 (0GHz-1GHz)	接触电阻 Contact resistance	中心导体 Center conductor	≤0.005Ω
		≤1.35 (0GHz-3GHz)		外导体 Outer conductor	≤0.0025Ω
	弯式 Right angle	≤1.50 (0GHz-1GHz)	频率范围 Frequency range		0GHz~3GHz
		≤1.63 (0GHz-3GHz)	寿命 Durability		500 Cycles

## 头部配合尺寸 INTERFACING DIMENSIONS

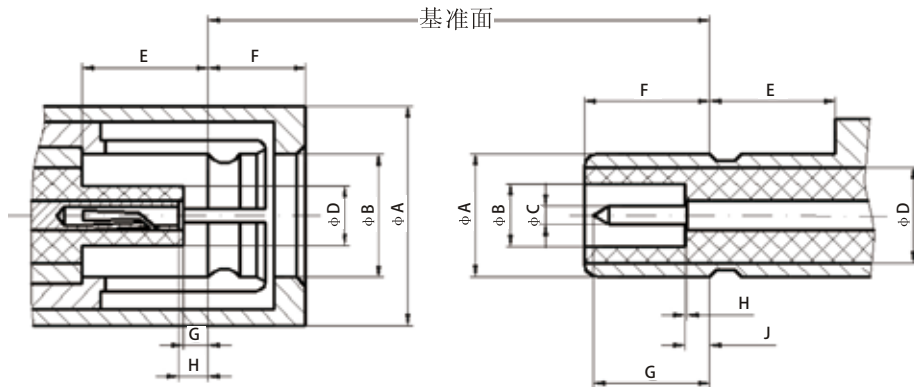

PLUG (mm)			JACK (mm)		
Symbol	MIN	MAX	Symbol	MIN	MAX
A	4.50	-	A	-	2.69
B	2.74	-	B	1.37	-
D	-	1.35	C	0.35	0.38
E	2.74	-	D	2.10	2.14
F	-	2.26	E	2.30	-
G	0.53	-	F	-	2.77
H	0.53	0.89	G	-	2.44
			H	0.00	0.13
			J	-	0.56

# SSMB系列射频同轴连接器



## 电缆连接器



SSMB-K2

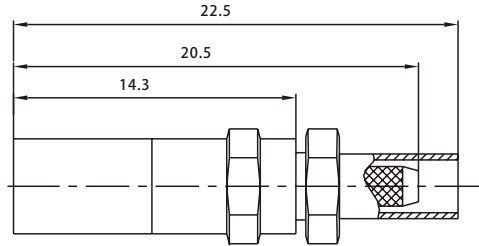

Type	Cable type
SSMB-K2	SFF-50-1 SYV-50-1



SSMB-JY2等

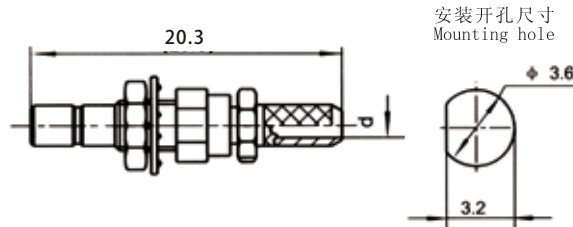

Type	d	Cable type
SSMB-JY2	φ 1	SFF-50-1 SYV-50-1
SSMB-JY3	φ 1.6	SFF-50-1.5-1 SYV-50-2-1



SSMB-KW2

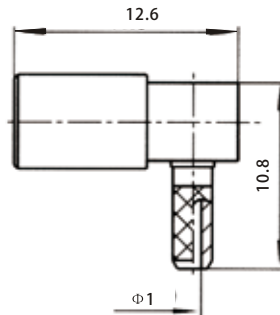

Type	Cable type
SSMB-KW2	SFF-50-1 SYV-50-1



SSMB-KW3

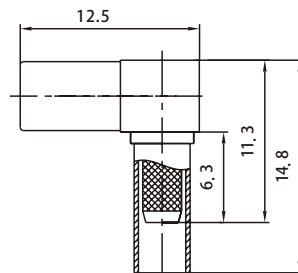

Type	Cable type
SSMB-KW3	SFF-50-1.5-1 SYV-50-2-1

## 面板连接器与印制电路板连接器



SSMB-JFD

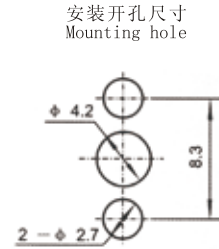
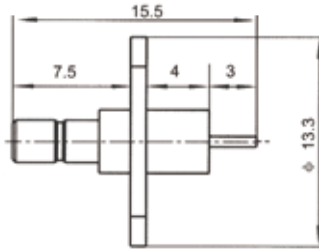

SSMB-JHD

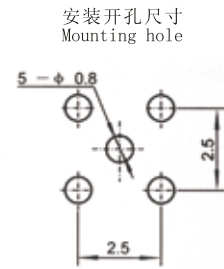
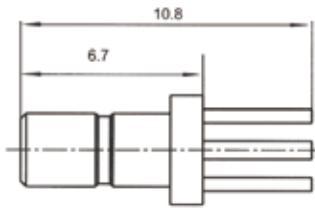

SSMB-JHD1

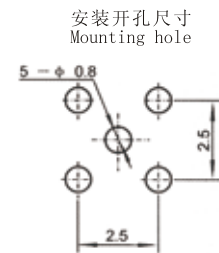
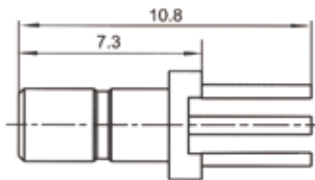

SSMB-JWHD

